

ESPL Judging Manual 2012

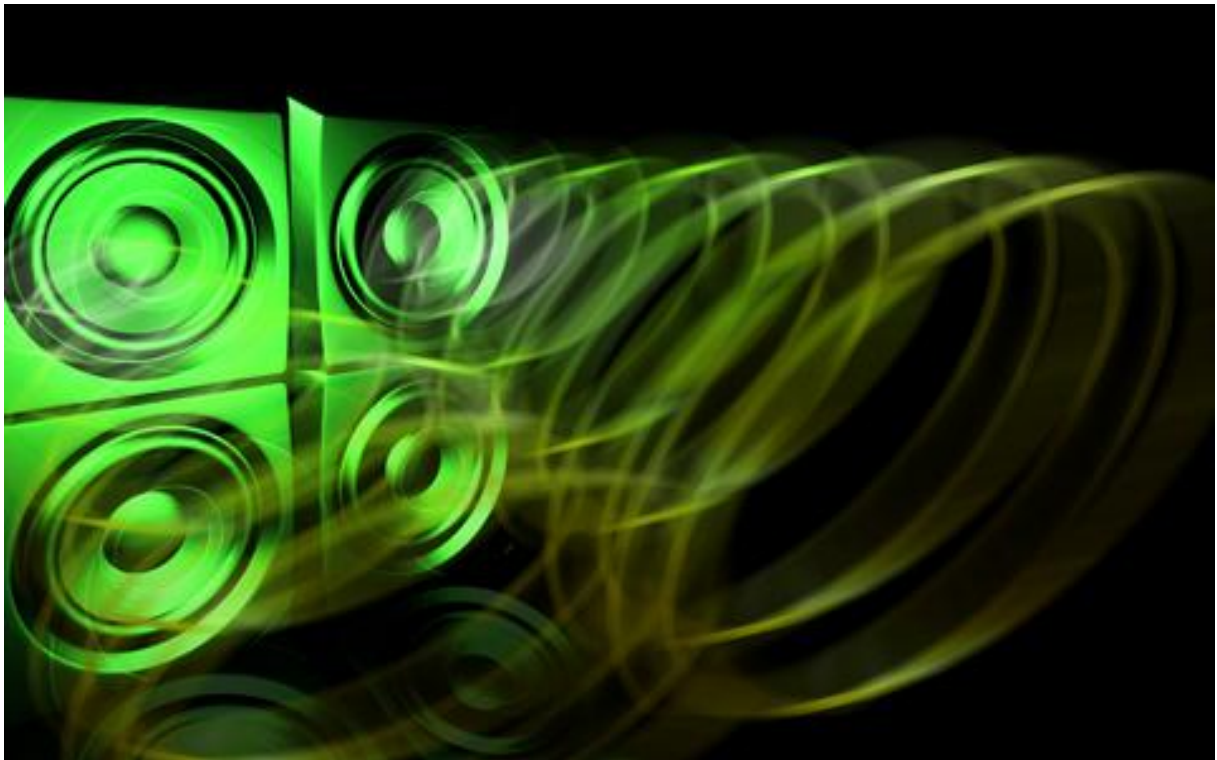

Ronald van Looij

Categories

All categories are similar in all classes!

TRUNK: Experienced and Advanced

Trunk means that the subwoofers, enclosure and port must be in the trunk.

Not higher than the original backseat without headrests, when the headrests are fixed to the backseat than you need commonsense and count them as headrests not as backseat.

The backseats must be in upright position, only from factory original is allowed.

During the measurements the backseats can be down or up, this is the decision of the competitor.

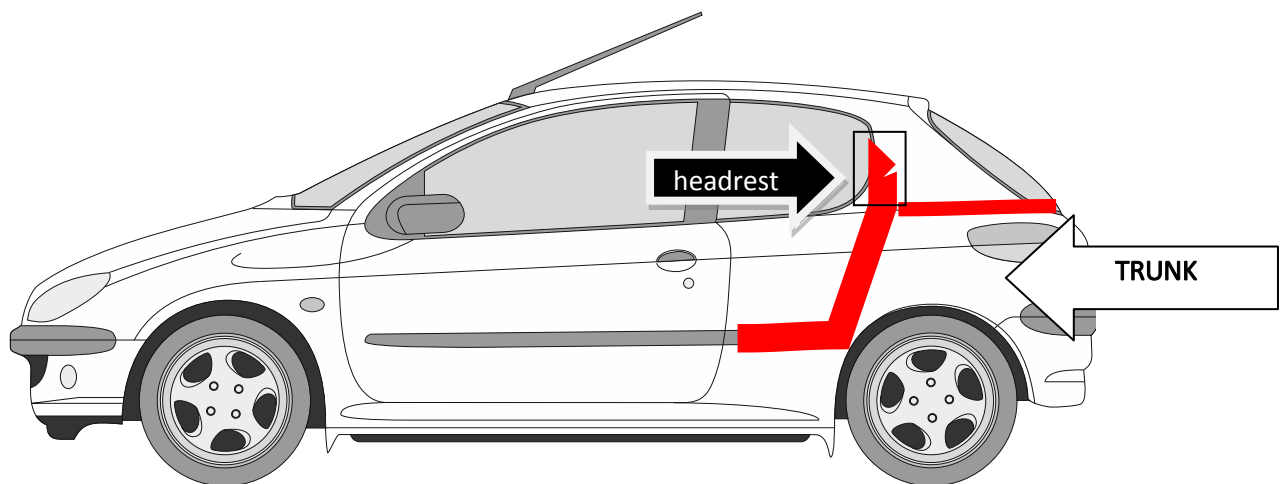

All the sound producing equipment including power supply (battery's, capacitor's, etc.) can be installed every ware, as long as it not infects the normal use of the car.

This means for TRUNK that the backseats must be usable as seats in a way it is intended by the factory. (NO BATTERY'S ETC. IN FRONT OF THE BACKSEAT)

B means B-pillar

B we have in:

Experienced, Advanced and Master

B means that the subwoofers, enclosure and port must be behind the (front) of the B-pillar and not higher than the original backseats without headrests.

There is no point for measurement, just follow the line of the B-pillar.

If the B-pillar has a curve, just follow the curve as measurement point.

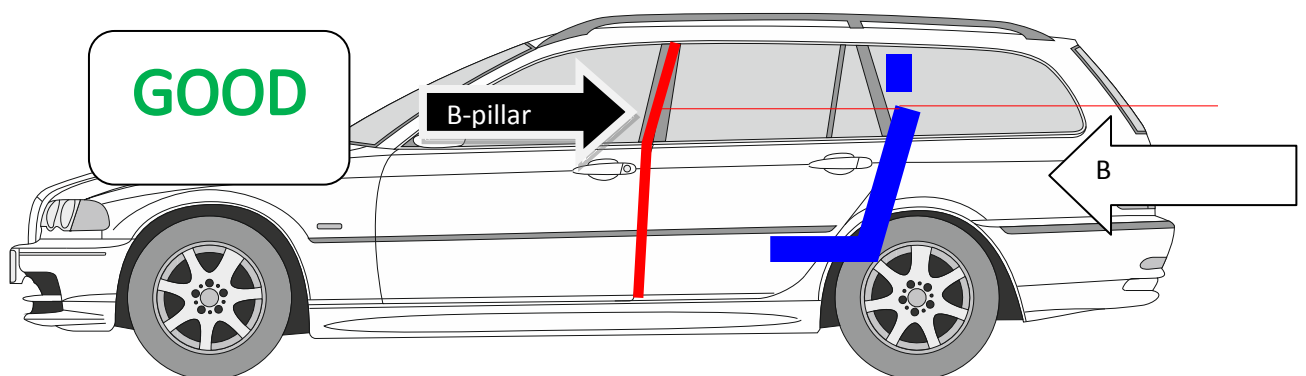

In me sketch the backseat is very high, just to give you an impression. As long as the backseat is original.

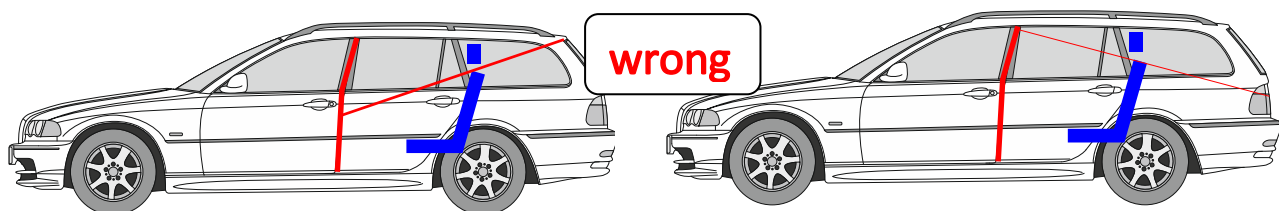

All the sound producing equipment including power supply (battery's, capacitor's, etc.) can be installed every ware, as long as it not infects the normal use of the car.

In Master B it's allowed to build battery's etc. On the place of the passengers side, be aware that the view through the windows stay clear.

W means Wall

W we have in:

Experienced, Advanced, Master and Expert.

W means that the subwoofers, enclosure and port must be installed behind the front of the B-pillar and can be up to the ceiling.

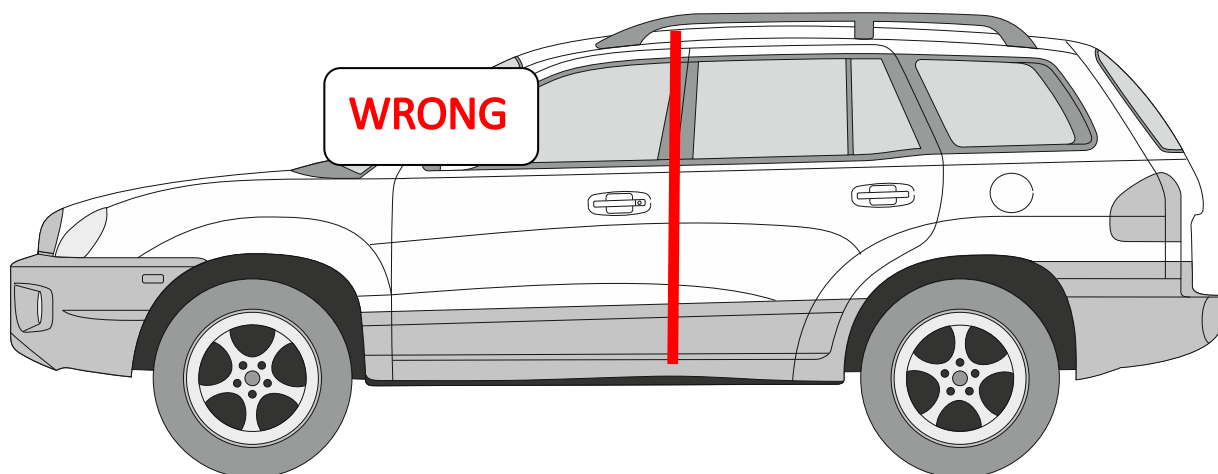
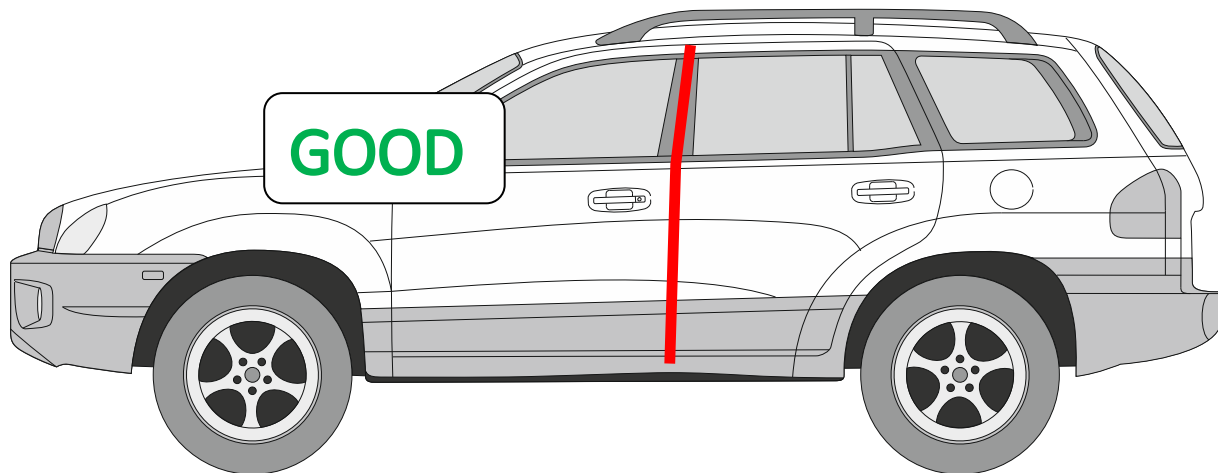

All the sound producing equipment including power supply (battery's, capacitor's, etc.) can be installed every ware, as long as it not infects the normal use of the car.

In Master and Expert W it's allowed to build battery's etc. On the place of the passengers side, be aware that the view through the windows stay clear.

In Experienced and Advanced the competitor is not allowed to take out the front seats.

This means that the seats must be usable as seats in a way it is intended by the factory.
(NO BATTERY'S ETC. IN FRONT OF THE SEATS)

Judging installation

Installation for ESPL is similar as SQ and MM, so you can use the “installation manual”

This is my addition, based on me experience.

4.2.1.

In ESPL there are a lot of competitors how us more than one battery.

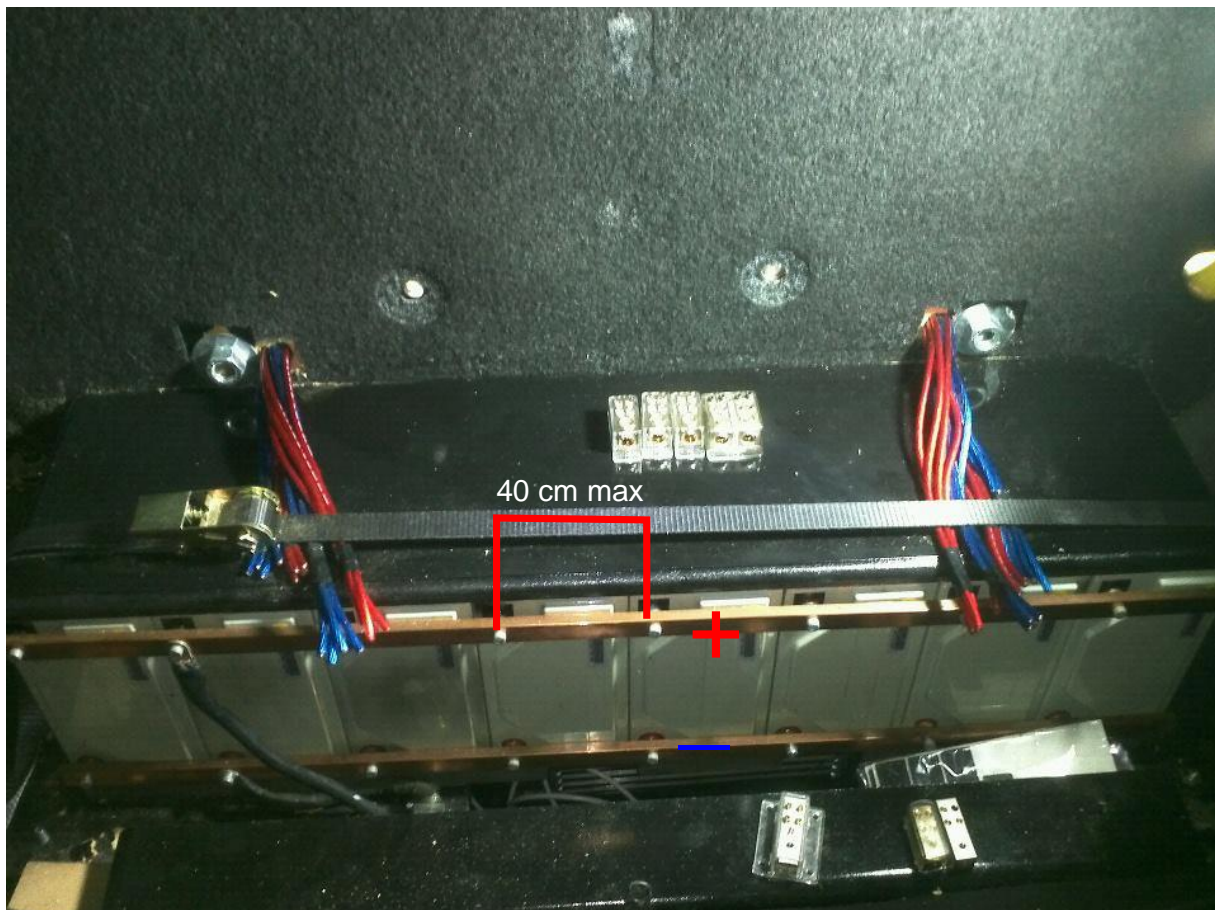

In this picture the metal bar is in total bigger than 40 cm.

If the distance between two poles is 40 cm or less we count it, if good protected from short circuit as GOOD.

4.3.5. First optic impression

Be aware that ESPL competitors are very easy thinking and often not making their installation real properly or just forget to do it.

When an enclosure is painted the screw holes must be filled before painting.

If meant as a design than do not deduced points, but then the screws must be really really really nice and proper (pointing the same way, distanced the same, all the same depth)

When you look into the port or Plexiglas window and see that the box inside is wood, then you need to deduced points for this. The inside of an enclosure must be finished if it is possible to look in it.

Here we have examples we don't like to see, and deduct points for.

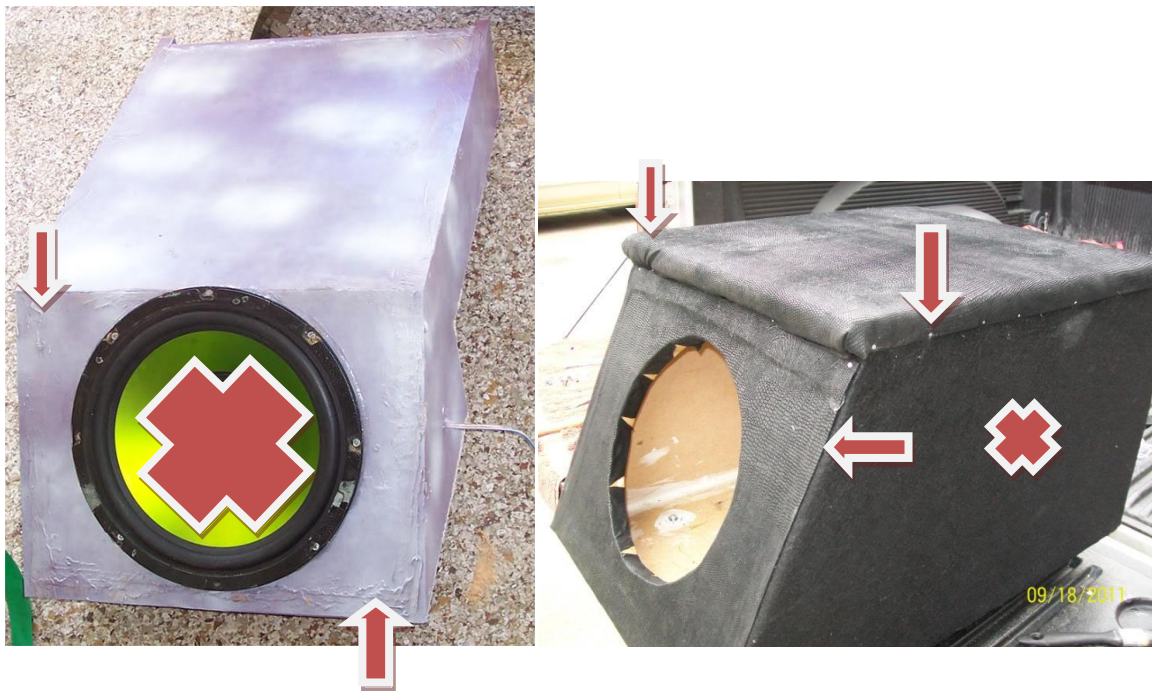

Measurement

For the measurement we use the ESPL tracks on the official EMMA disc.

The competitor is allowed to start where he wants, for example he wants to start at 1.32 from the track of your competition day.

It's not allowed to skip front or back in the track during the measurement.

All the competitors playing the same track during one competition.

Placing the sensor in the car.

The sensor must be in the **middle of the headrest**, on a wooden plate of 10 x10 cm.

The headrest have to be in down position (take care for this). If the headrest is fixed on the seat, than it must be factory original.

The driving seat must be in a driving position, use commonsense!

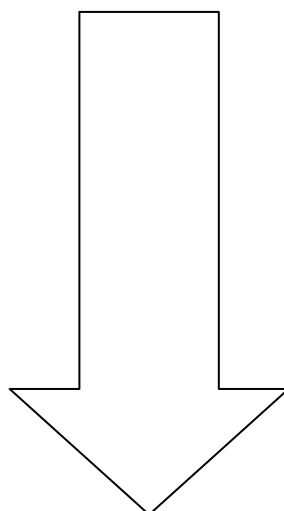

An example how to build the sensor plate.

I hope you all can do this better than me.





If you have questions ronald@emmanet.nl

Have a nice competition and a lot of fun.

Ronald van Looij BeNeLux

